

I.280

Handles

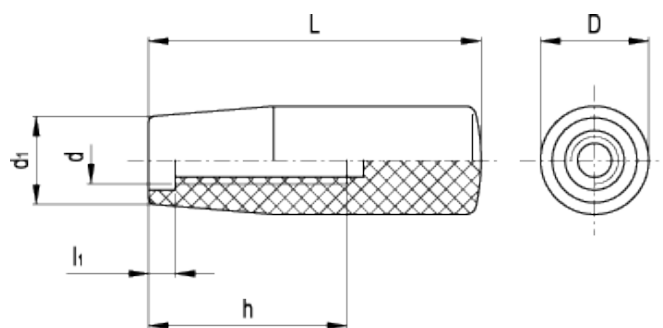

technical informations

Material

Phenolic based (PF) Duroplast. Resistant to solvents, oils, greases and other chemical agents.

Colour

Black, glossy finish.

Assembly

Tapped blind hole.

Standard Elements		Main dimensions			Mounting hole			Weight
Code	Description	L	D	d ₁	d	h	l ₁	g
21501	I.280/28-M5	28	14	11	M5	12	1.5	5
21601	I.280/40-M6	40	18	15	M6	25	3.5	12
21602	I.280/40-M8	40	18	15	M8	25	3.5	12
21701	I.280/50-M6	50	21	17	M6	25	3.5	21
21702	I.280/50-M8	50	21	17	M8	35	7.5	20
21801	I.280/65-M8	65	23	19	M8	30	7.5	33

21802	I.280/65-M10	65	23	19	M10	40	7.5	30
21803	I.280/65-M12	65	23	19	M12	40	7.5	28
21900	I.280/80-M8	80	26	21	M8	45	8	45
21901	I.280/80-M10	80	26	21	M10	55	7	47
21902	I.280/80-M12	80	26	21	M12	55	10	45
22000	I.280/90-M8	90	28	22	M8	45	7	62
22001	I.280/90-M10	90	28	22	M10	55	7	64
22002	I.280/90-M12	90	28	22	M12	58	8	62
22101	I.280/100-M12	102	31	25	M12	58	8	90
22102	I.280/100-M14	102	31	25	M14	65	5	85
22201	I.280/115-M12	116	29	23	M12	58	8	88



ELESA and GANTER models all rights reserved in accordance with the law. Always mention the source when reproducing our drawings.

STANDARD MACHINE ELEMENTS WORLDWIDE